

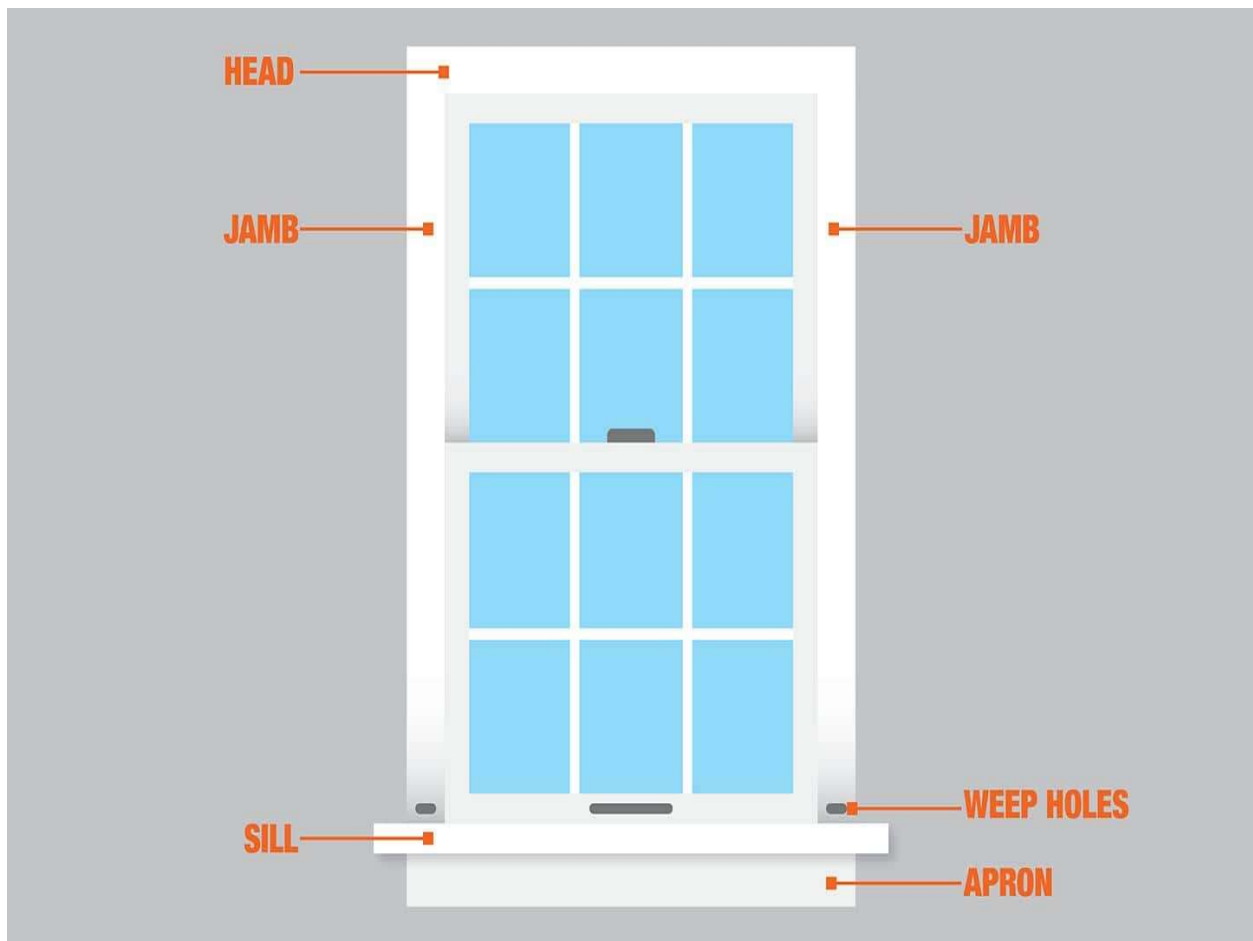

How to Measure Windows

Measuring windows to find the correct size for replacement is a simple DIY task. But take your time and get it right! You'll need an accurate size for a proper fit. Use this guide to learn how to measure for a window screen.

PARTS OF A WINDOW



Window styles vary, but the basic anatomy will be the same for all windows.

Starting from the bottom: the window's apron is mostly decorative. It also functions as a cover, hiding the space between the wall and the window frame.

The stool of the window is actually the interior sill. The words are used interchangeably, but the sill is technically on the exterior of the building, while the stool is the flat, shelf-like portion on the interior. The sill is required for structure and protection from rain, but it can also be decorative.

Not all windows have weep holes, but these small, rectangular holes let water drain out, keeping moisture from building up inside the window frame.

The inside casing, or trim, goes around the window, covering spaces between the frame and wall. The apron can also be considered a part of the trim.

The stool, apron, inside casing, and trim are all dressing for the window and are not considered part of the actual window.

The following are the window terms we use to measure:

- Sash: The moveable or fixed part of the window that holds the glass
- Head: The top part of the frame that touches the top of the sash
- Sill: The bottom part of the frame that touches the bottom of the sash
- Jamb: The vertical pieces on either side of the frame that touch the sides of the sash

HOW TO MEASURE FOR A NEW WINDOW SCREEN

Learning how to measure window screens is straightforward. If a screen is being replaced and the existing damaged screen is available – or another window of the same size has a screen – measure the width, height, and depth of the existing screen. You will want to get as exact a measurement as you can (the closest 1/16 or 1/8) to ensure the screen will fit. If you can, you can bring it in to us and we can measure for you.

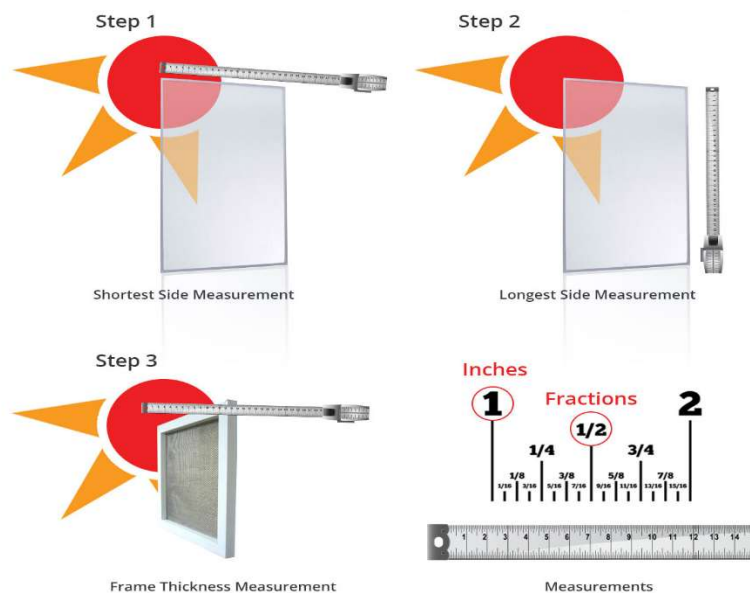

If a screen is being added to a window that does not currently have one:



- Open the window and measure the distance between the screen channels on the window frame as exactly as you can. You

want to get to the actual inside edges of where the screen will sit. Subtract 1/8 inch from this measurement for the width dimension: this will allow the screen room to fit within the window and have a little room for movement.



- To determine the height of the new screen, raise the window sash and measure up from the lip (the ridge that holds the screen in place) along the screen channel to the sash, as exactly as you can. Add 1/8 inch to the measurement for the height dimension. This will allow the screen to fit inside the lip but allow the lip to hold it into place.

- To determine the depth/thickness of your screen, measure the space between the channel lips on one side and note that. Common screen thicknesses are 5/16-, 3/8-, and 7/16-inch, but if

you bring in your measurements we can determine the best fit.

- You did it! These are the measurements you will need for us to build your new screen.